

KJELLERPLAN MARINEHOLMEN

BASEN/ PP3

55 plasser

MK1/ PP4

78 plasser

MK4/ PP5

38 plasser

MK5/ PP6

38 plasser

MAGASINET/ PP7

32 plasser

SUM

241 P-PASSER

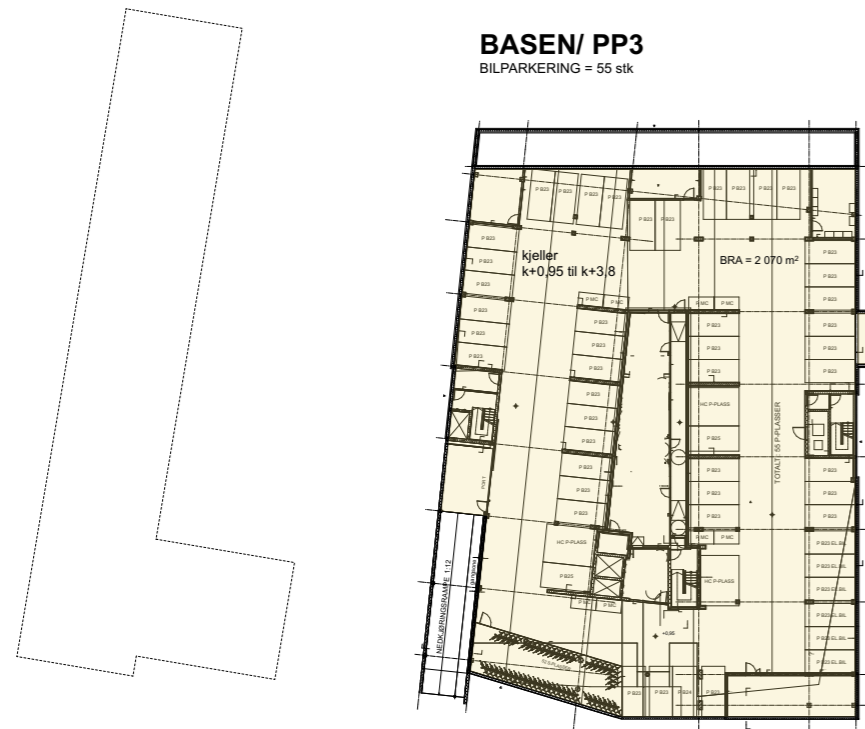

MK1/ PP4

BILPARKERING = 78 stk

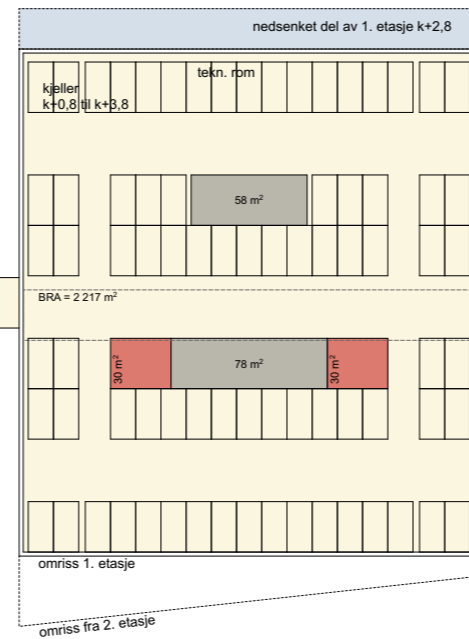

MK4/ PP5

BILPARKERING = 38 stk

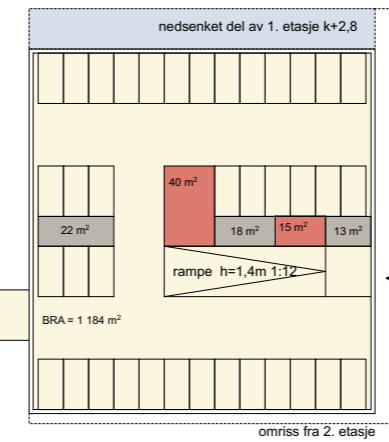

INNKJØRSEL
RAMPE

MK5/ PP6

BILPARKERING = 38 stk

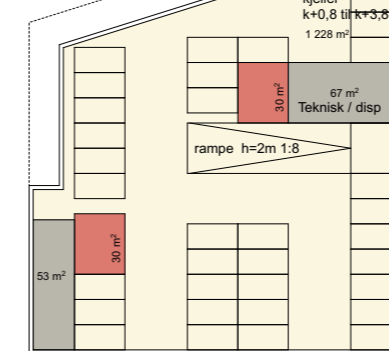

INNKJØRSEL
RAMPE

MAGASINET/ PP7

BILPARKERING = 32 stk

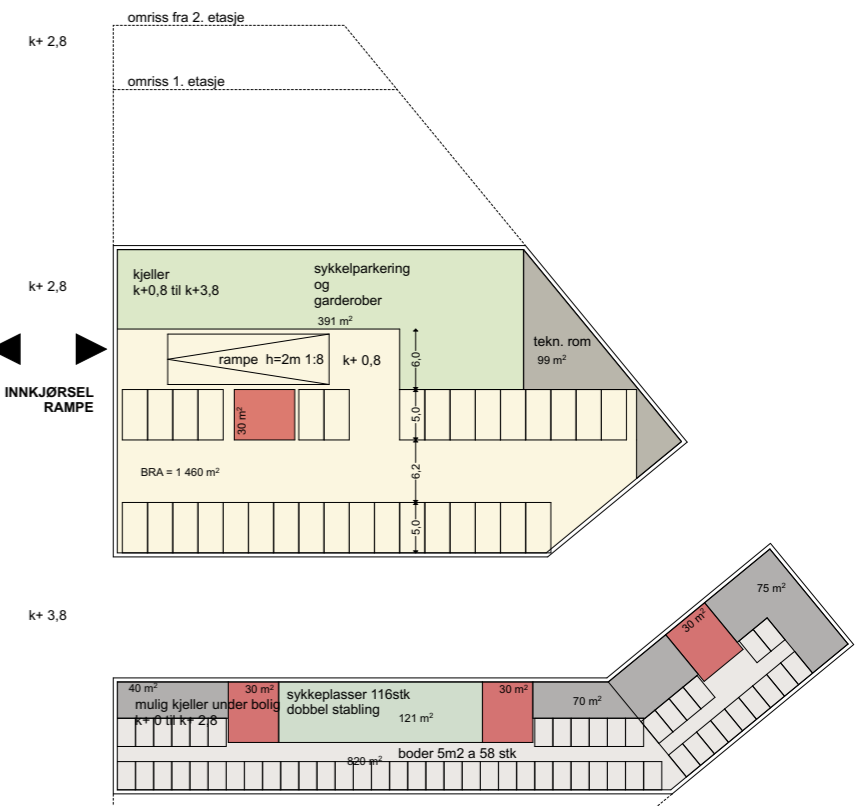

BOLOGNA/ KBA14+KBA15

SYKKEL 13.335*0,025= 340stk (*0,9m2/sykkel) = 310m2
SPORTSBODER = 170 stk (*5+1,5m2) = 1.105m2

KBA14

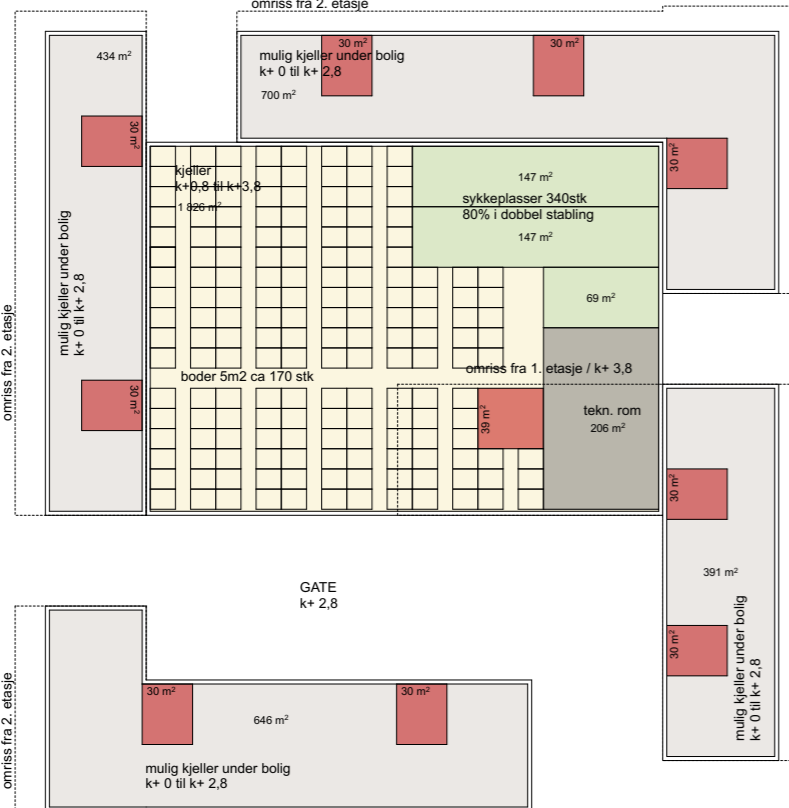

KBA15

MK2/ KBA16

BILPARKERING = - stk

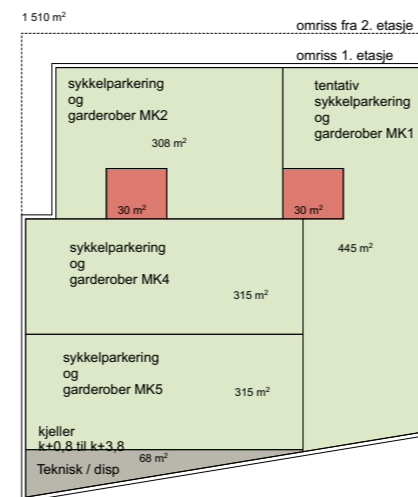

GATE
k+ 3,8

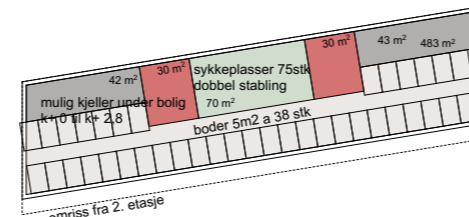

MK3/ KBA17

SYKKEL 3.000*0,025= 75stk (*0,9m2/sykkel) = 70m2
SPORTSBODER = 38 stk (*5+1,5m2) = 250m2

LANTERNEN/ KBA8

BILPARKERING = - stk

